

**OTHER MATERIAL EXCHANGE/
REUSE PROGRAMS:**

The County of Los Angeles offers a County-Wide Material Exchange Program. It is designed to help residents, businesses and other entities in Los Angeles County find markets for their industrial by-products, surplus materials, and other would-be discards. For details, please contact 1-800-CLEAN LA (1-888-253-2652) or visit at www.lacomax.com.

The State of California offers a State-Wide Material Exchange Program. Businesses, non-profits, and other entities can place free ads for materials they are disposing or for items they need. For details, please contact 1-877-520-9703 or visit the website at www.ciwmb.ca.gov/CalMax/.

Reusable equipment can be obtained for free or at a minimal cost to the recipient.

The US Department of Treasury-IRS Publication 78, 'Cumulative List of Organizations' lists the names of organizations eligible to receive tax deductible contributions, as well as the percentage of the contribution that is deductible. Please refer to IRS Publication 78 or consult your tax advisor to claim income tax deductions for these donations.

And Remember ...
SMART RECYCLING WORKS

Standard Presorted Mail
U.S. Postage
PAID
Los Angeles, CA
Permit No. 12932

City of Los Angeles
Department of Public Works • Bureau of Sanitation
SOLID RESOURCES CITYWIDE RECYCLING DIVISION
1149 So. Broadway, 10th Floor
Los Angeles, CA 90015
Phone: (213) 485-2260 • Fax: (213) 485-3671



As a covered entity under Title II of the Americans with Disabilities Act, the City of Los Angeles does not discriminate on the basis of disability and, upon request, will provide reasonable accommodation to ensure equal access to its programs, services and activities.

PRINTED ON RECYCLED PAPER



City of Los Angeles
Department of Public Works
Bureau of Sanitation



Let's Reuse LA!

A REUSE PROGRAM FOR BUSINESSES

Made possible by a grant from



Solid Resources
Citywide Recycling
Division

*Reduce, Reuse, Recycle,
and Buy Recycled*



"Don't just stand there; recycle something!"
-Recycle Robot

www.ciwmb.ca.gov
www.lacity.org/san



California State Law requires that all cities divert 50% of their solid waste stream by the year 2000.

The City of Los Angeles in its efforts to reduce solid waste disposal has exceeded the 50% goal and is now aiming for the 75% diversion of solid waste by the year 2013.

WHAT IS THE REUSE NETWORK?

It is a part of the City's strategy to reach 75% diversion by 2013. Through the businesses listed in this brochure, you can direct your unwanted office equipment to non-profit agencies for further reuse.

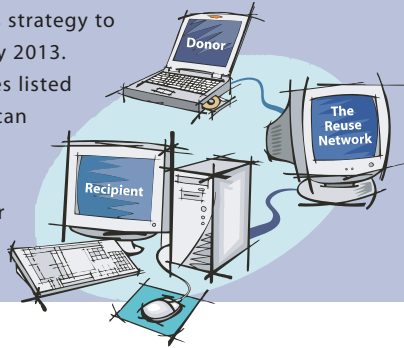

THE GOAL

The reuse network will establish a link between local business and reuse agencies, and develop a reuse program into a self-expanding sustainable program. This is a cost-effective way to assist the City of Los Angeles in meeting its solid waste diversion goals with your support and participation.

This program will also assist local businesses, organizations and institutions to find alternatives to the disposal of valuable materials which are presently discarded as waste.



YOUR SUCCESS STORIES

Please help us keep track of the success of our program.

Share your success stories with us online at <http://san.lacity.org> or call us at 213-485-2260.

WHO CAN PARTICIPATE

- ✓ A local corporation that is upgrading its office;
- ✓ A wholesaler who has outdated office equipment, inventory surplus or discontinued items; or
- ✓ An office keeping up with modern technology;

WHAT CAN BE DONATED

All functional office equipment, including, but not limited to:

computers	printers	fax machines
calculators	telephones	desks
chairs	file cabinets	televisions
video cassette players/recorders	stereo players/recorders	paper shredders and other office supplies

WHAT YOUR DONATION CAN DO

- ✓ Assist schools and non-profit organizations to receive desperately needed materials
- ✓ Conserve landfill space
- ✓ Eliminate disposal costs
- ✓ Conserve virgin raw materials and conserve the energy needed to process new products
- ✓ Claim an Income Tax deduction (consult your tax advisor)
- ✓ Assist the City of Los Angeles meet its 75% Solid Waste Diversion goal by the year 2013.

This network will allow you to make direct contact with the reuse agencies. These agencies have a distribution network and infrastructure in place and will make sure that your gift is reused to its fullest potential.

FOR MORE INFORMATION!

For a complete directory of donation opportunities, please visit our web site at www.lacity.org/san/ and view our publication "Put It To Good Re-Use LA" or contact us at 213-485-2260 for more information.



REUSE AGENCIES

LA SHARES

3223 Riverside Drive
Los Angeles, CA 90027
Phone: (213) 485-1097
Fax: (213) 485-9237
Hours: 9am-5pm Mon-Fri

GOOD WILL INDUSTRIES OF SOUTHERN CALIFORNIA

342 San Fernando Road
Los Angeles, CA 90031
Phone: (323) 223-1211
Fax: (323) 343-9927
Hours: 9:00am-5pm Mon-Sun

THE SOCIETY OF ST. VINCENT DE PAUL

210 N. Avenue 21
Los Angeles, CA 90031
Phone: (323) 224-6288
Fax: (323) 225-4997
Hours: 9:30am-5:45pm Mon-Sat
9:30am-4:00pm Sun

CENTRAL CITY NEIGHBORHOOD PARTNERS

501 S. Bixel Street
Los Angeles, CA 90017
Phone: (213) 482-8618
Fax: (213) 241-0909
Hours: 8:30am-8:30pm Mon-Fri
9:00am-3:00pm Sat

PUEBLO NUEVO

1738 W. 7th Street
Los Angeles, CA 90017
Phone: (213) 483-1178
Fax: (213) 483-7082
Hours: 11:00am-7pm Mon-Sat

THE SALVATION ARMY

1334 Alamos Ave.
Long Beach, CA 90813
Phone: 562-218-2355
Hours: 7:30am-4:00pm Mon-Fri
10:00am-7:00pm Sat & Sun